

YG-DCO-012-A(C)

Yorkshire Green Energy Enablement (GREEN) Project

Volume 2

Document 2.5.2(C) Land Plan Section B

Final Issue C

April 2023

Planning Inspectorate Reference: EN020024

Infrastructure Planning (Applications: Prescribed Forms and
Procedure) Regulations 2009 Regulation 5(2)(i) - (ii)(iii)

nationalgrid



NATIONAL GRID (YORKSHIRE GREEN ENERGY ENABLEMENT PROJECT) ORDER
 LAND KEY PLAN
 REGULATION 5(2)(i) - (ii)(iii)
 SECTION B, SHEET 1 OF 1

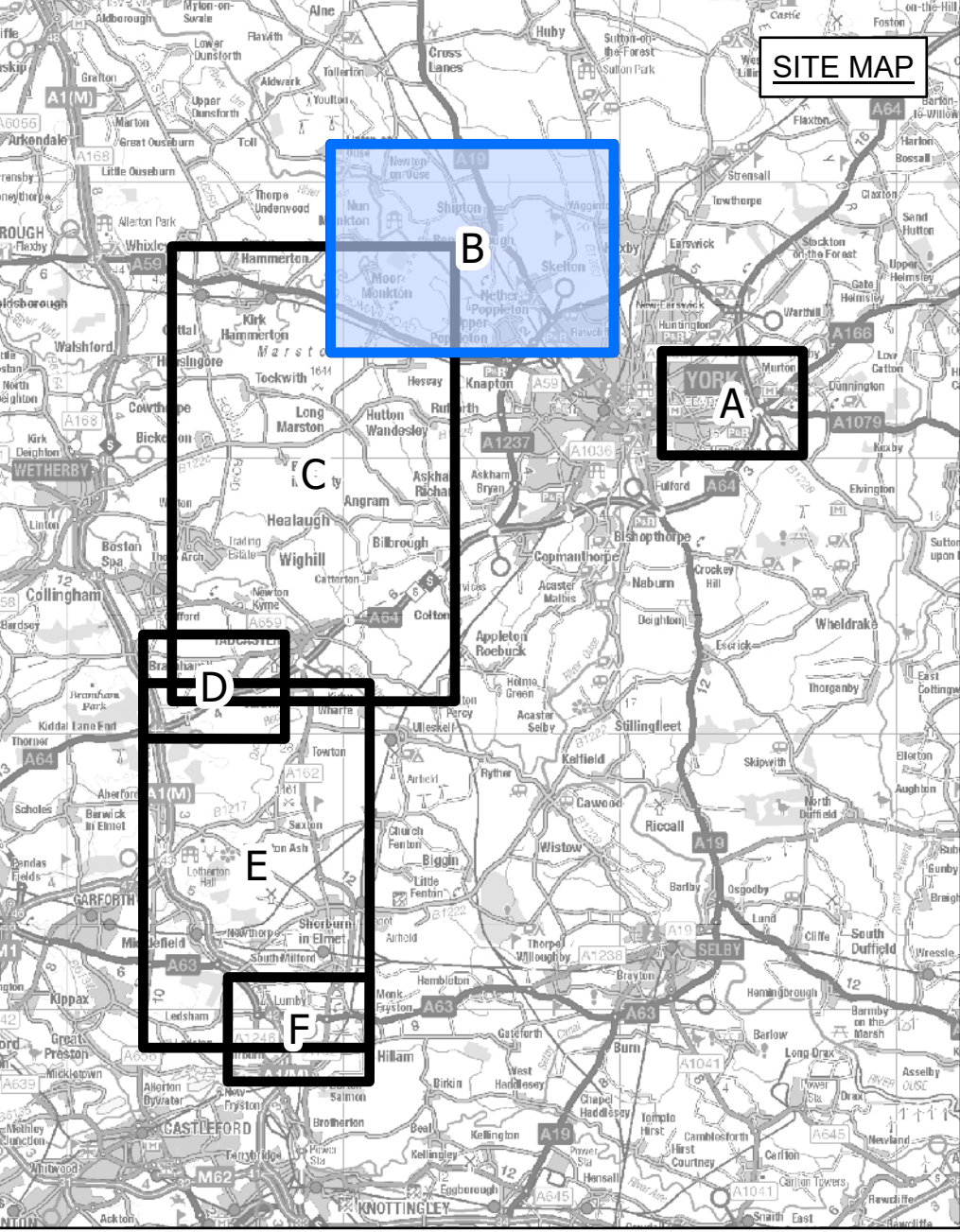

- LEGEND**
- - - LOCAL AUTHORITY BOUNDARY
 - - - SECTION BOUNDARY
 - ORDER LIMITS
 - SHEET INDEX

Notes
 This drawing is scaled at paper size A0, therefore any prints taken at smaller sizes will affect accuracy of the measurement units and should not be scaled against.

For additional detail on the plan sites, please refer to Document 2.3 Plan Guidance Document, located in Volume 2 of the DCO Application.

The local authorities' boundaries and titles are correct at the time of submission. North Yorkshire County Council and its 7 districts are expected to form a new single council (North Yorkshire Council) on 1 April 2023.

Coordinate System: British National Grid
 Sheet X Centroid Coordinate: 455410 Sheet Y Centroid Coordinate: 457592

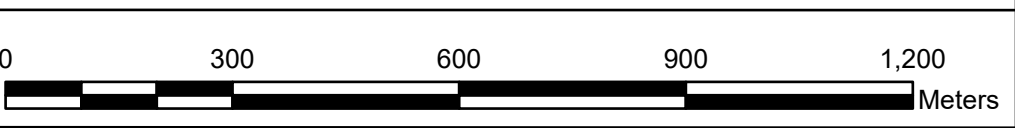

BACKGROUND MAPPING INFORMATION HAS BEEN REPRODUCED FROM THE ORDNANCE SURVEY BY PERMISSION OF ORDNANCE SURVEY OF THE CONTROLLER OF HER MAJESTY'S STATIONERY OFFICE. CROWN COPYRIGHT ORDNANCE SURVEY © BLUESKY INTERNATIONAL LTD © NATIONAL GRID ELECTRICITY - 100024241.

Issue	Date	Remarks	Drawn	Checked	Approved
A	01/11/2022	FOR DCO SUBMISSION	MG	SF	EMD

Title
 NATIONAL GRID (YORKSHIRE GREEN ENERGY ENABLEMENT PROJECT) ORDER
 LAND KEY PLAN
 REGULATION 5(2)(i) - (ii)(iii)
 SECTION B, SHEET 1 OF 1

nationalgrid

Application Number EN020024

National Grid Drawing Reference
 DCO_B/LP/KP/01

Scale	Sheet Size	Sheet	Issue
1:10,000	A0	SHEET 1 OF 1	A

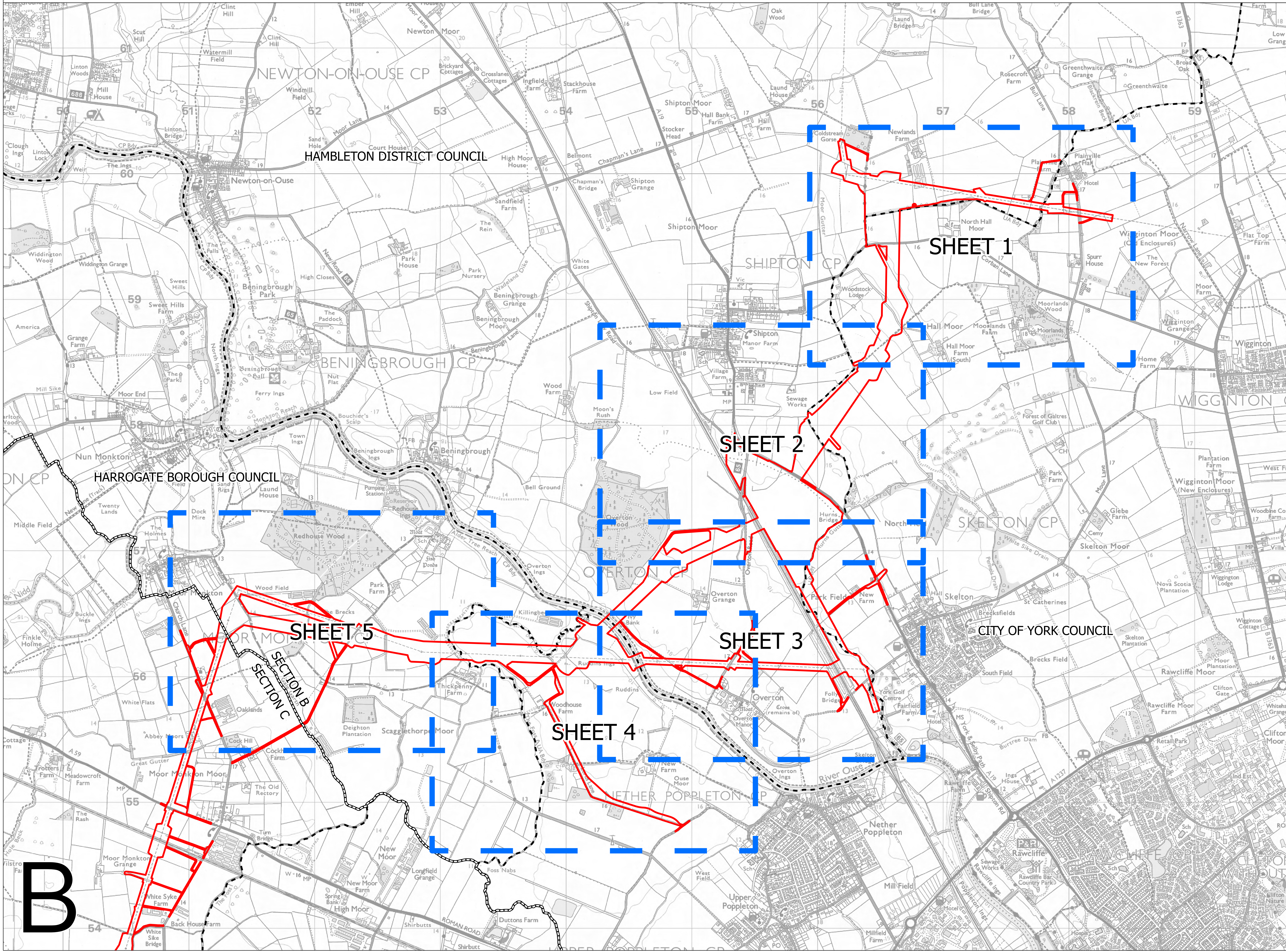



NATIONAL GRID (YORKSHIRE GREEN ENERGY ENABLEMENT PROJECT) ORDER
 LAND PLAN
 REGULATION 5(2)(i) - (ii)(iii)
 SECTION B, SHEET 1 OF 5

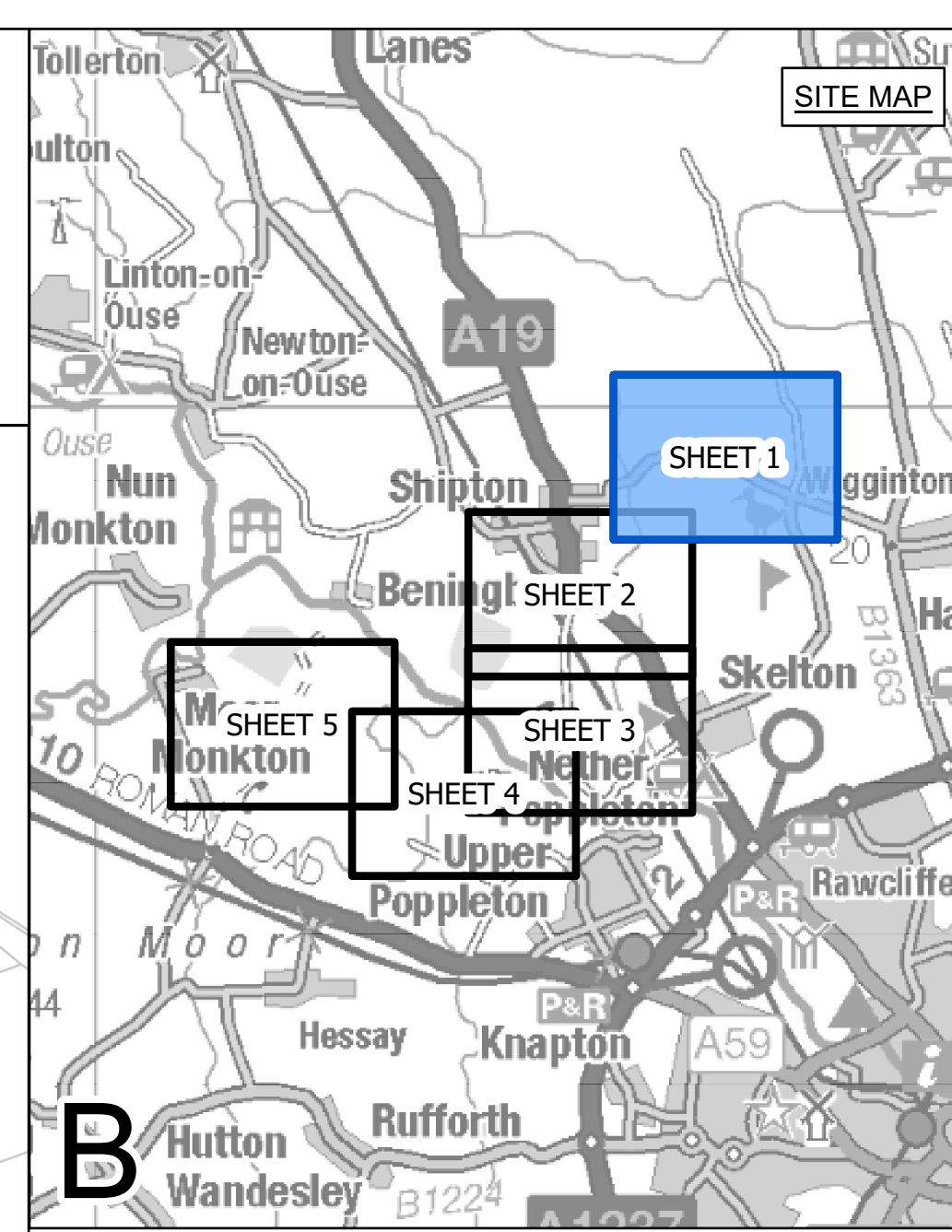
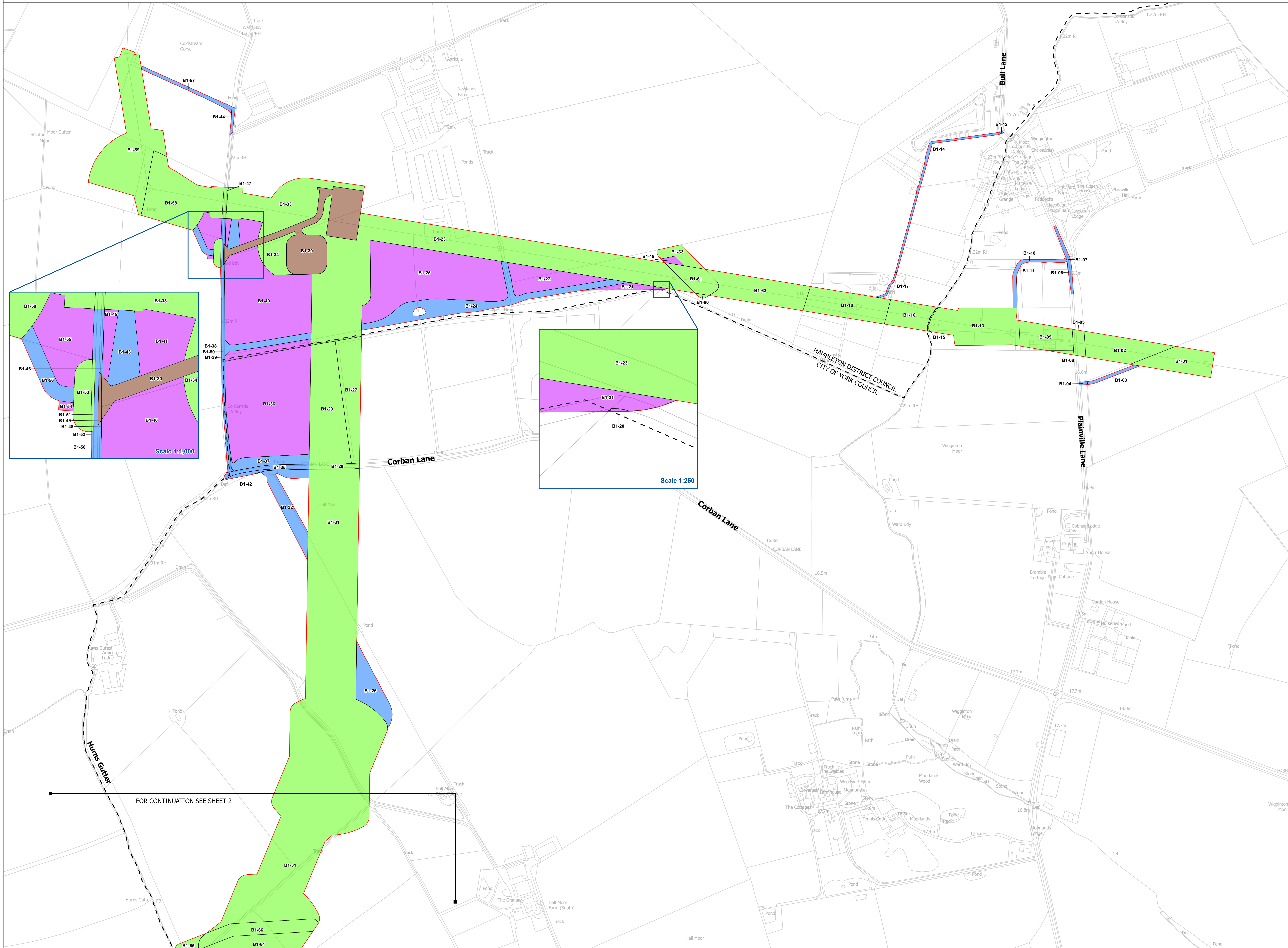

- LEGEND**
- LOCAL AUTHORITY BOUNDARY
 - SECTION BOUNDARY
 - ORDER LIMITS
- PLOTS**
- CLASS 1 - COMPULSORY ACQUISITION OF LAND
 - CLASS 2 - COMPULSORY ACQUISITION OF RIGHTS FOR THE AUTHORISED DEVELOPMENT
 - CLASS 3 - COMPULSORY ACQUISITION OF RIGHTS OF ACCESS
 - CLASS 4 - TEMPORARY USE FOR CONSTRUCTION AND MITIGATION
 - CLASS 5 - TEMPORARY USE FOR DISMANTLING
 - CLASS 6 - TEMPORARY USE FOR ACCESS

Notes
 This drawing is scaled at paper size A0, therefore any prints taken at smaller sizes will affect accuracy of the measurement units and should not be scaled against.

All easements, servitudes and private rights are proposed to be extinguished on land that is to be acquired unless stated otherwise in the Book of Reference (Volume 4, Document 4.3).

For additional detail on the plan suites, please refer to Document 2.3 Plan Guidance Document, located in Volume 2 of the DCO Application.

The local authorities' boundaries and titles are correct at the time of submission. North Yorkshire County Council and its 7 districts are expected to form a new single council (North Yorkshire Council) on 1 April 2023.

Coordinate System: British National Grid
 Sheet X Centroid Coordinate: 456581 Sheet Y Centroid Coordinate: 459424



BACKGROUND MAPPING INFORMATION HAS BEEN REPRODUCED FROM THE ORDNANCE SURVEY BY PERMISSION OF ORDNANCE SURVEY OF THE CONTROLLER OF HER MAJESTY'S STATIONERY OFFICE. CROWN COPYRIGHT ORDNANCE SURVEY ©. BLUESKY INTERNATIONAL LTD ©. NATIONAL GRID ELECTRICITY - 100024241.

Issue	Date	Remarks	Drawn	Checked	Approved
C	26/04/2023	FOR DEADLINE TWO	MG	SF	EMD
B	14/02/2023	S51 ADVICE UPDATE	MG	SF	EMD
A	01/11/2022	FOR DCO SUBMISSION	MG	SF	EMD

Title
 NATIONAL GRID
 (YORKSHIRE GREEN ENERGY
 ENABLEMENT PROJECT) ORDER
 LAND PLAN
 REGULATION 5(2)(i) - (ii)(iii)
 SECTION B, SHEET 1 OF 5



Application Number
 EN020024

National Grid Drawing Reference
 DCO_B/LP/PS/01

Scale	Sheet Size	Sheet	Issue
1:2,500	A0	SHEET 1 OF 5	C



NATIONAL GRID (YORKSHIRE GREEN ENERGY ENABLEMENT PROJECT) ORDER
 LAND PLAN
 REGULATION 5(2)(i) - (ii)(iii)
 SECTION B, SHEET 2 OF 5

Shipton by Beningbrough

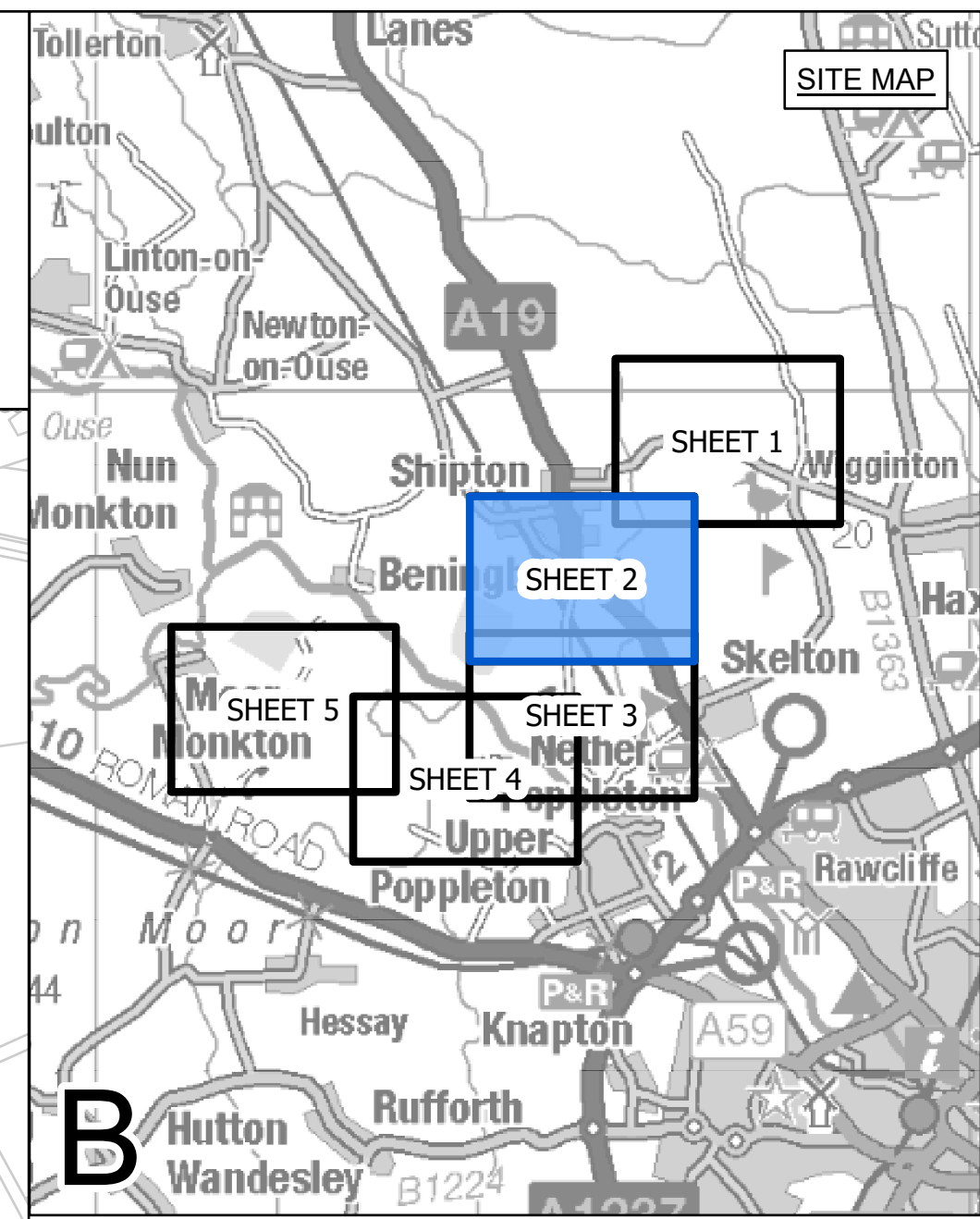

- LEGEND**
- LOCAL AUTHORITY BOUNDARY
 - SECTION BOUNDARY
 - ORDER LIMITS
- PLOTS**
- CLASS 1 - COMPULSORY ACQUISITION OF LAND
 - CLASS 2 - COMPULSORY ACQUISITION OF RIGHTS FOR THE AUTHORISED DEVELOPMENT
 - CLASS 3 - COMPULSORY ACQUISITION OF RIGHTS OF ACCESS
 - CLASS 4 - TEMPORARY USE FOR CONSTRUCTION AND MITIGATION
 - CLASS 5 - TEMPORARY USE FOR DISMANTLING
 - CLASS 6 - TEMPORARY USE FOR ACCESS

Notes
 This drawing is scaled at paper size A0, therefore any prints taken at smaller sizes will affect accuracy of the measurement units and should not be scaled against.

All easements, servitudes and private rights are proposed to be extinguished on land that is to be acquired unless stated otherwise in the Book of Reference (Volume 4, Document 4.3).

For additional detail on the plan suites, please refer to Document 2.3 Plan Guidance Document, located in Volume 2 of the DCO Application.

The local authorities' boundaries and titles are correct at the time of submission. North Yorkshire County Council and its 7 districts are expected to form a new single council (North Yorkshire Council) on 1 April 2023.

Coordinate System: British National Grid
 Sheet X Centroid Coordinate: 455555 Sheet Y Centroid Coordinate: 457851



BACKGROUND MAPPING INFORMATION HAS BEEN REPRODUCED FROM THE ORDNANCE SURVEY BY PERMISSION OF ORDNANCE SURVEY OF THE CONTROLLER OF HER MAJESTY'S STATIONERY OFFICE. CROWN COPYRIGHT ORDNANCE SURVEY ©. BLUESKY INTERNATIONAL LTD ©. NATIONAL GRID ELECTRICITY - 100024241.

Issue	Date	Remarks	Drawn	Checked	Approved
C	26/04/2023	FOR DEADLINE TWO	MG	SF	EMD
B	14/02/2023	S51 ADVICE UPDATE	MG	SF	EMD
A	01/11/2022	FOR DCO SUBMISSION	MG	SF	EMD

Title
 NATIONAL GRID
 (YORKSHIRE GREEN ENERGY ENABLEMENT PROJECT) ORDER
 LAND PLAN
 REGULATION 5(2)(i) - (ii)(iii)
 SECTION B, SHEET 2 OF 5

nationalgrid			
Application Number	EN020024		
National Grid Drawing Reference	DCO_B/LP/PS/02		
Scale	Sheet Size	Sheet	Issue
1:2,500	A0	SHEET 2 OF 5	C

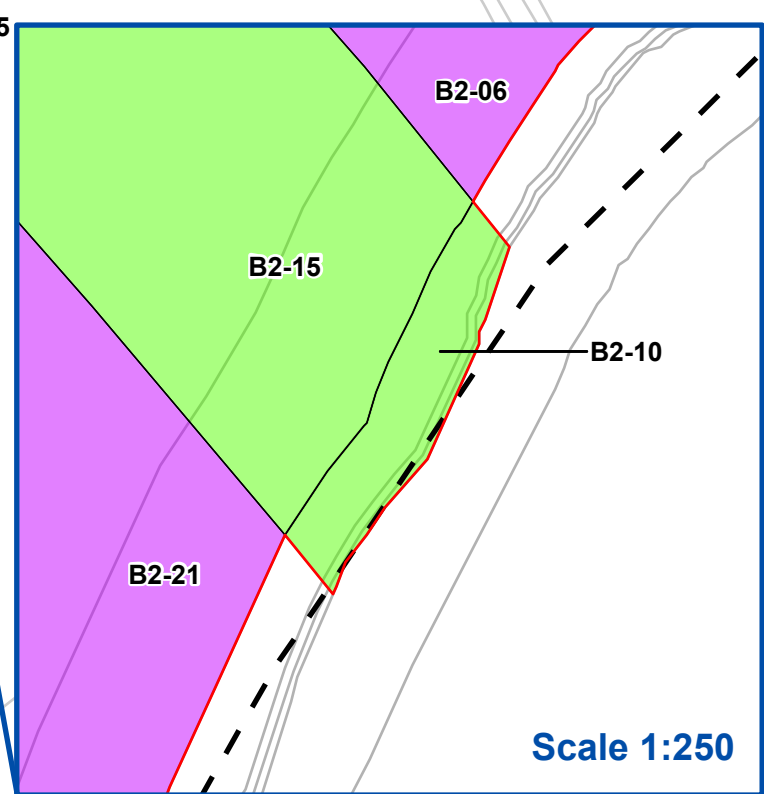
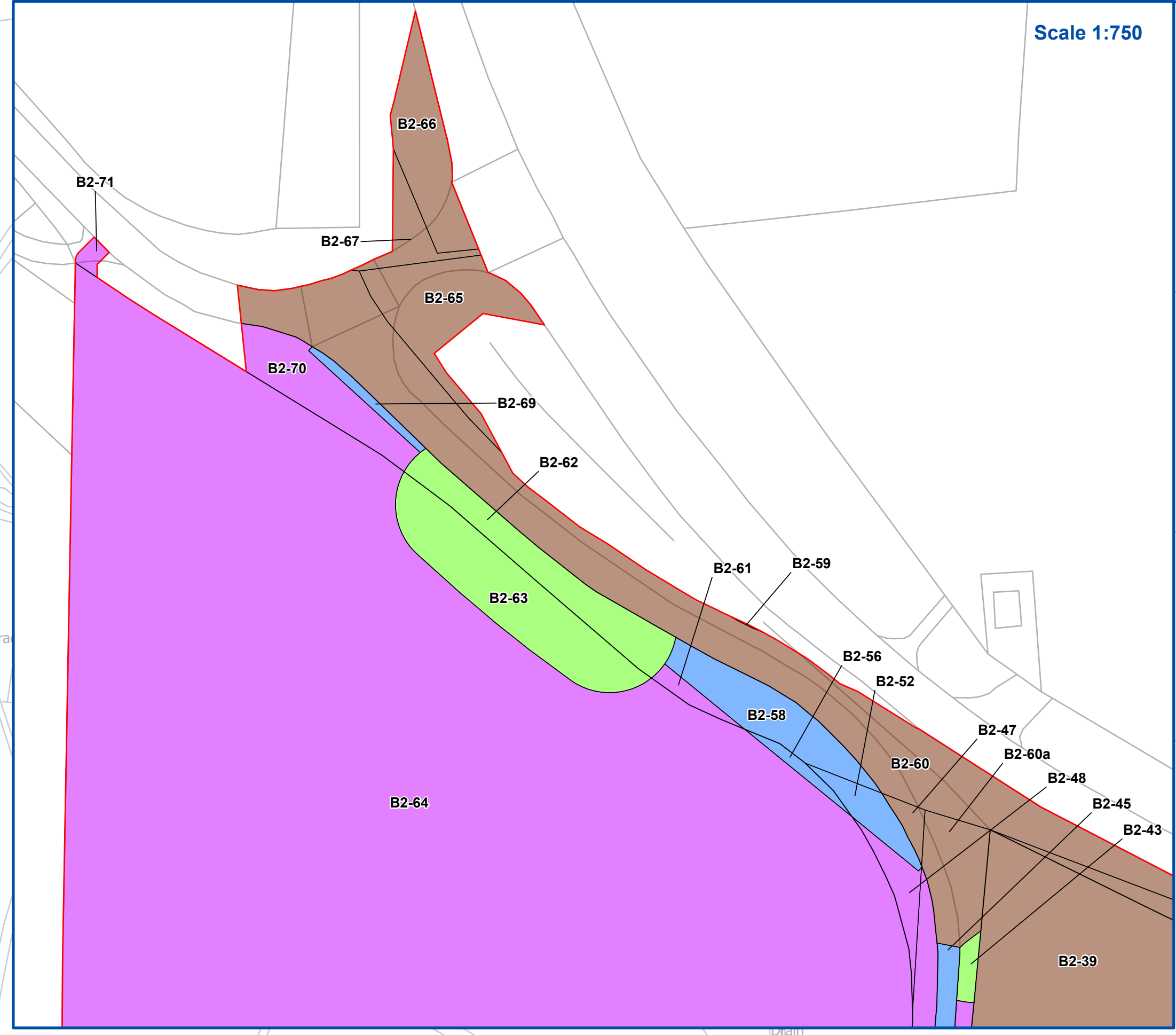
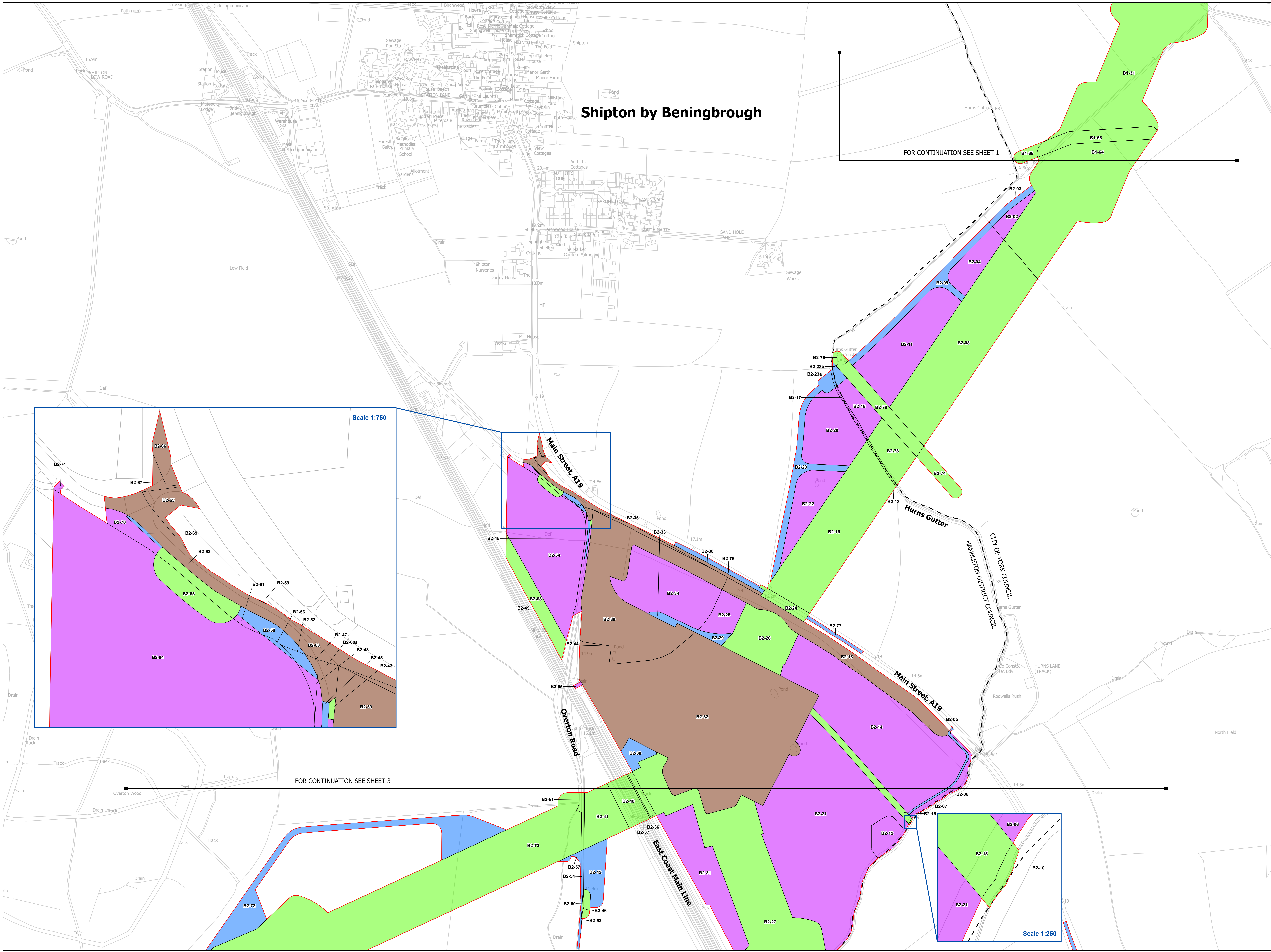



NATIONAL GRID (YORKSHIRE GREEN ENERGY ENABLEMENT PROJECT) ORDER
 LAND PLAN
 REGULATION 5(2)(i) - (ii)(iii)
 SECTION B, SHEET 3 OF 5

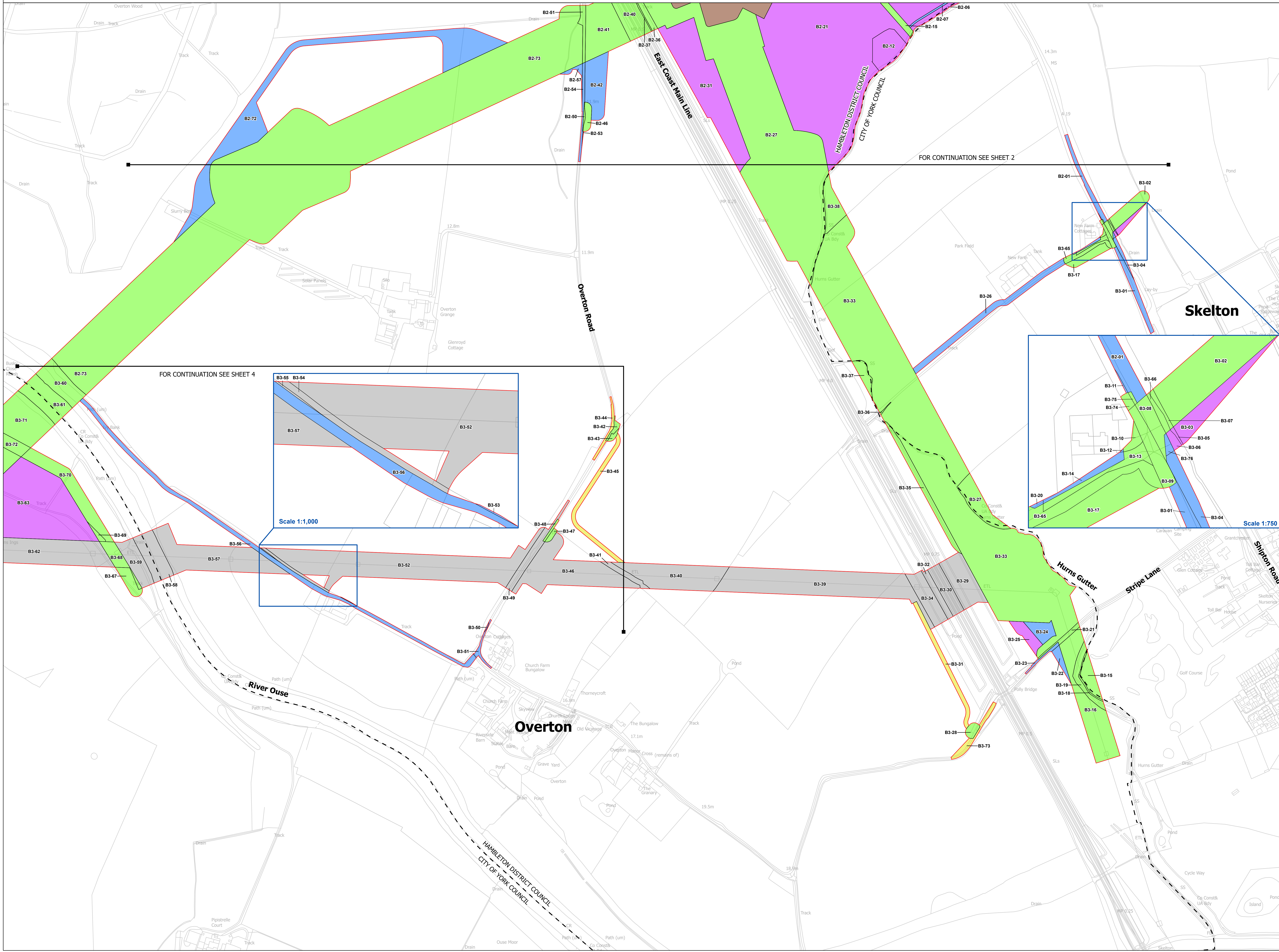
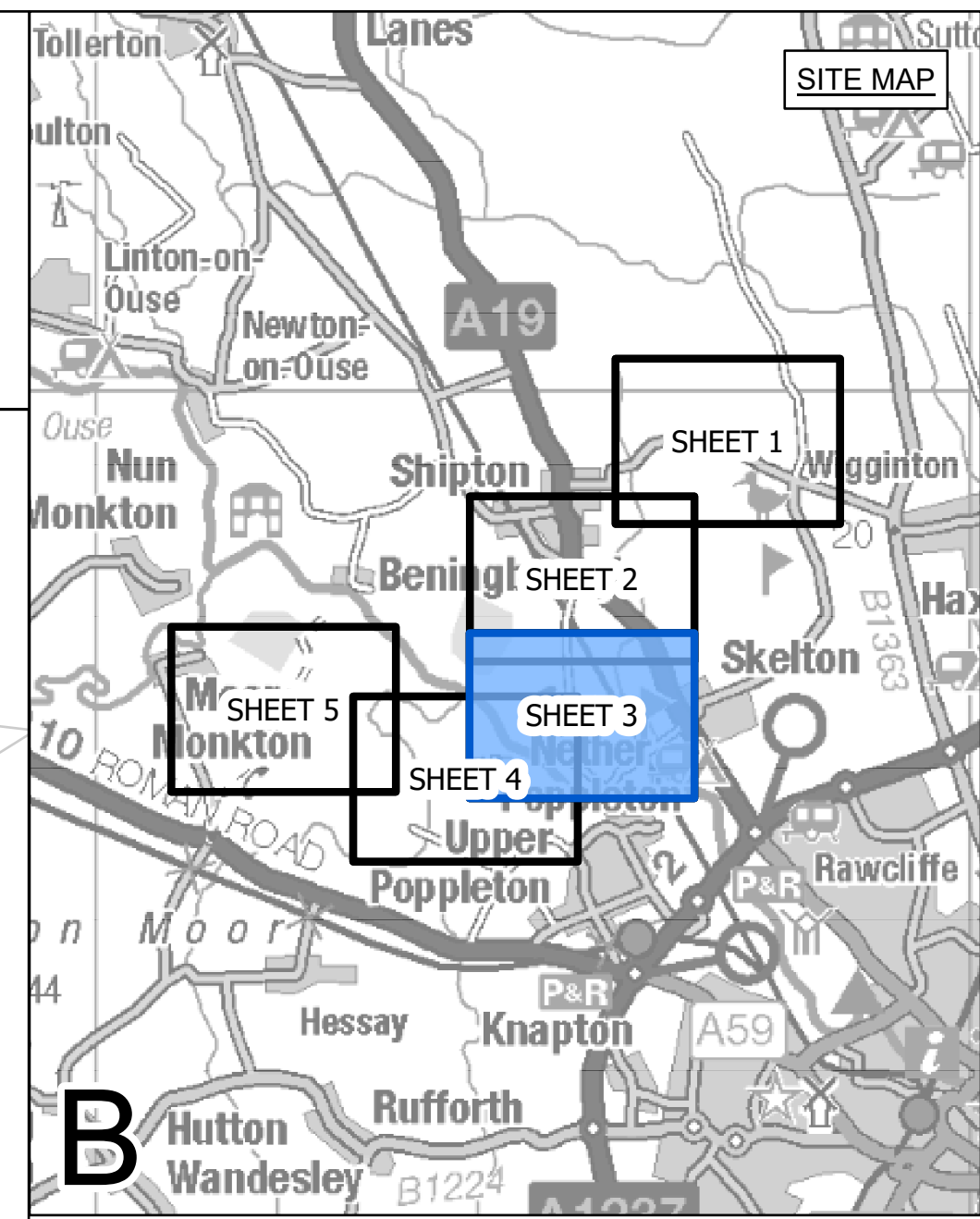

- LEGEND**
- - LOCAL AUTHORITY BOUNDARY
 - ▬ SECTION BOUNDARY
 - ▭ ORDER LIMITS
- PLOTS**
- CLASS 1 - COMPULSORY ACQUISITION OF LAND
 - CLASS 2 - COMPULSORY ACQUISITION OF RIGHTS FOR THE AUTHORISED DEVELOPMENT
 - CLASS 3 - COMPULSORY ACQUISITION OF RIGHTS OF ACCESS
 - CLASS 4 - TEMPORARY USE FOR CONSTRUCTION AND MITIGATION
 - CLASS 5 - TEMPORARY USE FOR DISMANTLING
 - CLASS 6 - TEMPORARY USE FOR ACCESS

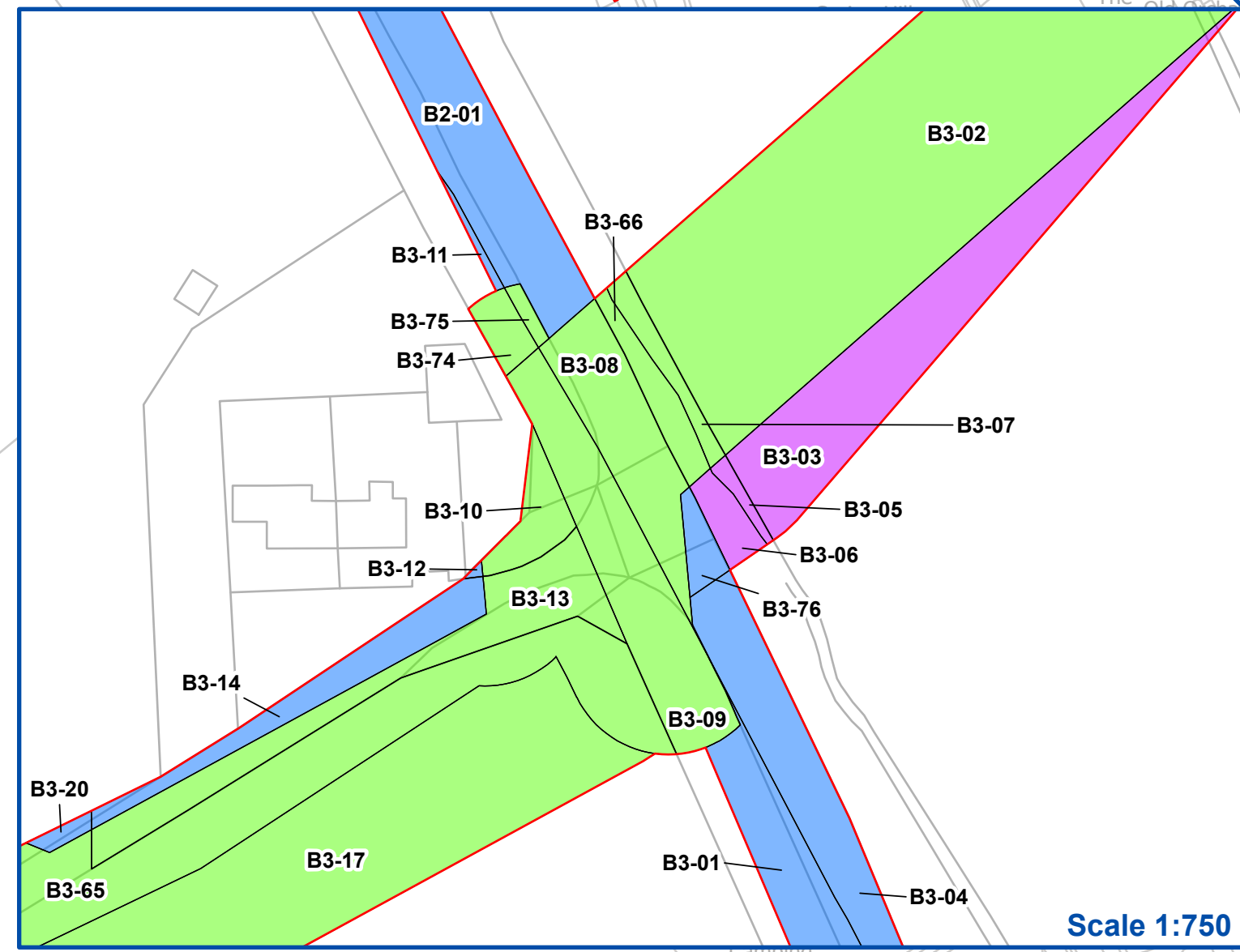
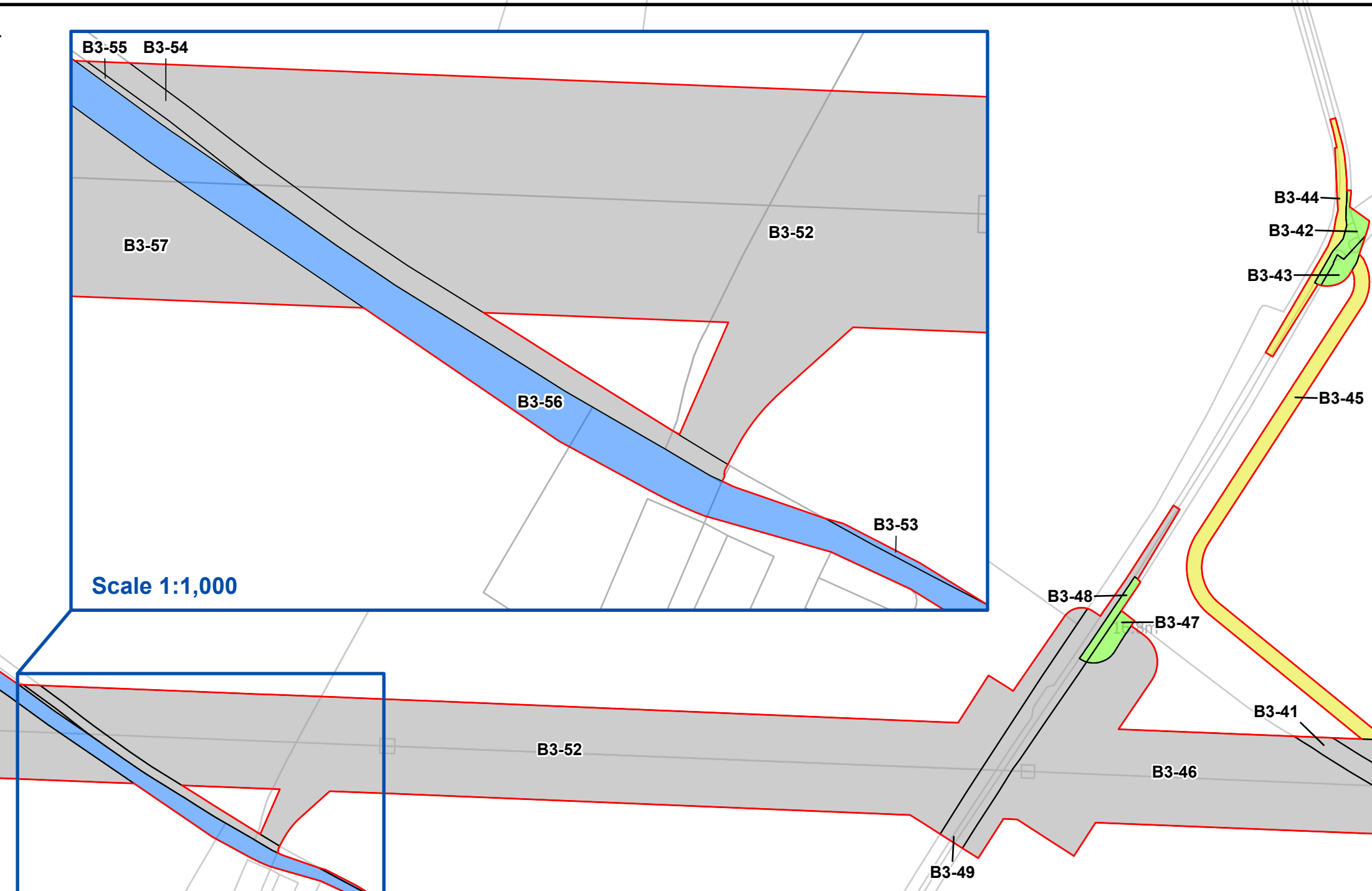

Notes
 This drawing is scaled at paper size A0, therefore any prints taken at smaller sizes will affect accuracy of the measurement units and should not be scaled against.

All easements, servitudes and private rights are proposed to be extinguished on land that is to be acquired unless stated otherwise in the Book of Reference (Volume 4, Document 4.3).

For additional detail on the plan suites, please refer to Document 2.3 Plan Guidance Document, located in Volume 2 of the DCO Application.

The local authorities' boundaries and titles are correct at the time of submission. North Yorkshire County Council and its 7 districts are expected to form a new single council (North Yorkshire Council) on 1 April 2023.

Coordinate System: British National Grid
 Sheet X Centroid Coordinate: 455553 Sheet Y Centroid Coordinate: 456286



BACKGROUND MAPPING INFORMATION HAS BEEN REPRODUCED FROM THE ORDNANCE SURVEY BY PERMISSION OF ORDNANCE SURVEY OF THE CONTROLLER OF HER MAJESTY'S STATIONERY OFFICE. CROWN COPYRIGHT ORDNANCE SURVEY © BLUESKY INTERNATIONAL LTD © NATIONAL GRID ELECTRICITY - 100024241.

Issue	Date	Remarks	Drawn	Checked	Approved
C	26/04/2023	FOR DEADLINE TWO	MG	SF	EMD
B	14/02/2023	SS1 ADVICE UPDATE	MG	SF	EMD
A	01/11/2022	FOR DCO SUBMISSION	MG	SF	EMD

Title
 NATIONAL GRID
 (YORKSHIRE GREEN ENERGY
 ENABLEMENT PROJECT) ORDER
 LAND PLAN
 REGULATION 5(2)(i) - (ii)(iii)
 SECTION B, SHEET 3 OF 5



Application Number: EN020024

National Grid Drawing Reference: DCO_B/LP/PS/03

Scale	Sheet Size	Sheet	Issue
1:2,500	A0	SHEET 3 OF 5	C



NATIONAL GRID (YORKSHIRE GREEN ENERGY ENABLEMENT PROJECT) ORDER
 LAND PLAN
 REGULATION 5(2)(i) - (ii)(iii)
 SECTION B, SHEET 4 OF 5

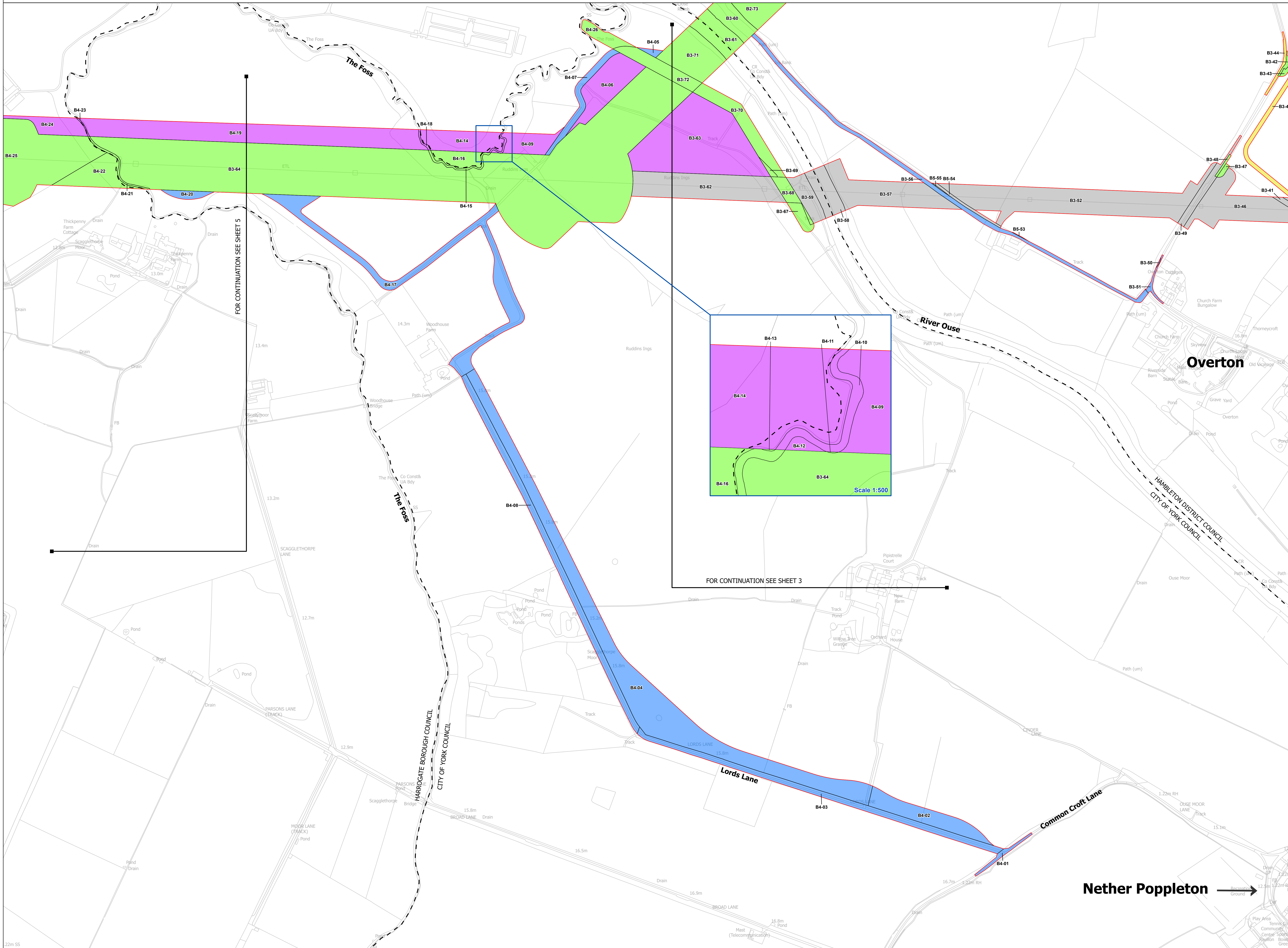
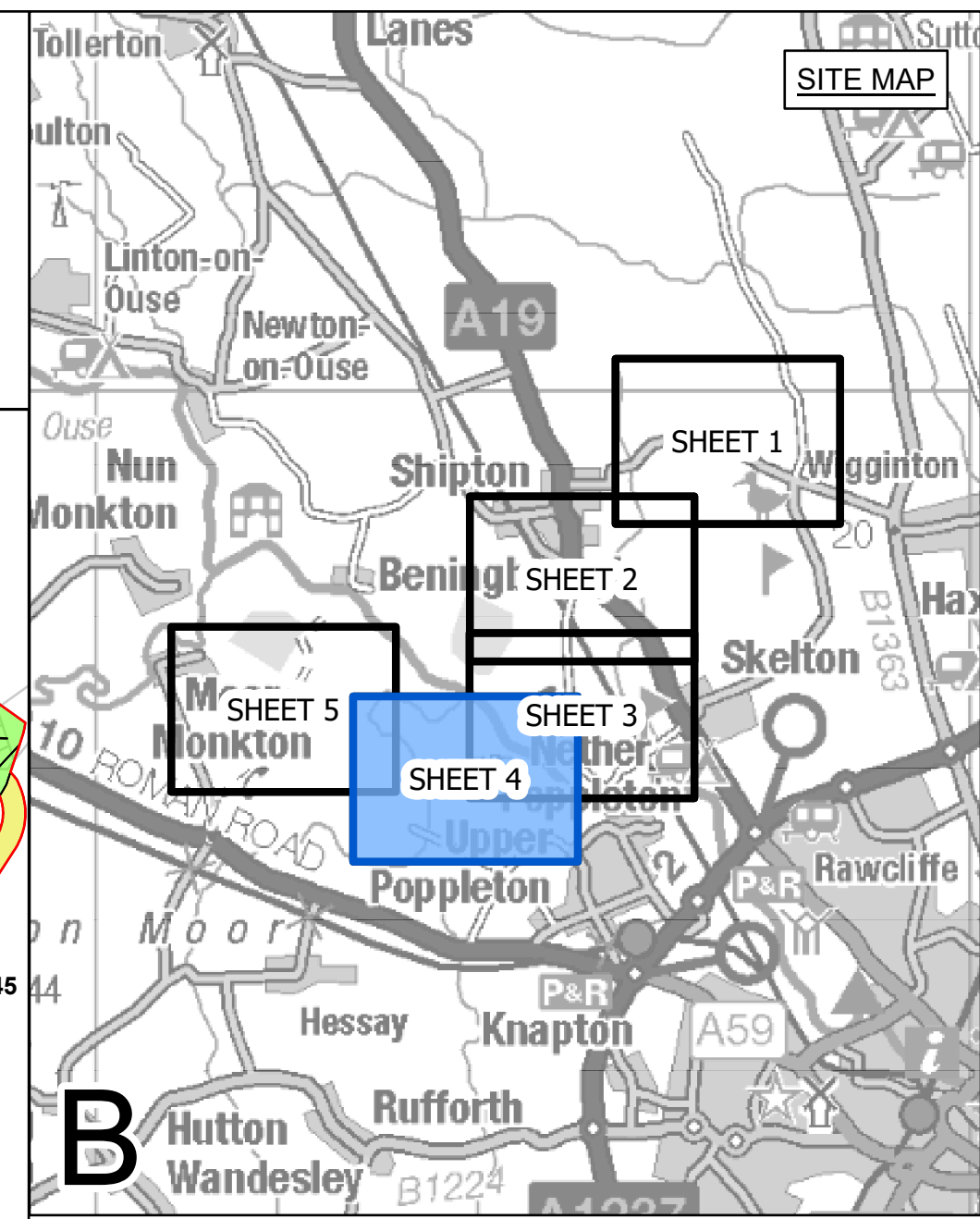

- LEGEND**
- LOCAL AUTHORITY BOUNDARY
 - SECTION BOUNDARY
 - ORDER LIMITS
- PLOTS**
- CLASS 1 - COMPULSORY ACQUISITION OF LAND
 - CLASS 2 - COMPULSORY ACQUISITION OF RIGHTS FOR THE AUTHORISED DEVELOPMENT
 - CLASS 3 - COMPULSORY ACQUISITION OF RIGHTS OF ACCESS
 - CLASS 4 - TEMPORARY USE FOR CONSTRUCTION AND MITIGATION
 - CLASS 5 - TEMPORARY USE FOR DISMANTLING
 - CLASS 6 - TEMPORARY USE FOR ACCESS

Notes
 This drawing is scaled at paper size A0, therefore any prints taken at smaller sizes will affect accuracy of the measurement units and should not be scaled against.

All easements, servitudes and private rights are proposed to be extinguished on land that is to be acquired unless stated otherwise in the Book of Reference (Volume 4, Document 4.3).

For additional detail on the plan suites, please refer to Document 2.3 Plan Guidance Document, located in Volume 2 of the DCO Application.

The local authorities' boundaries and titles are correct at the time of submission. North Yorkshire County Council and its 7 districts are expected to form a new single council (North Yorkshire Council) on 1 April 2023.

Coordinate System: British National Grid
 Sheet X Centroid Coordinate: 454220 Sheet Y Centroid Coordinate: 455561



BACKGROUND MAPPING INFORMATION HAS BEEN REPRODUCED FROM THE ORDNANCE SURVEY BY PERMISSION OF ORDNANCE SURVEY OF THE CONTROLLER OF HER MAJESTY'S STATIONERY OFFICE. CROWN COPYRIGHT ORDNANCE SURVEY ©. BLUESKY INTERNATIONAL LTD ©. NATIONAL GRID ELECTRICITY - 100024241.

Issue	Date	Remarks	Drawn	Checked	Approved
C	26/04/2023	FOR DEADLINE TWO	MG	SF	EMD
B	14/02/2023	SS1 ADVICE UPDATE	MG	SF	EMD
A	01/11/2022	FOR DCO SUBMISSION	MG	SF	EMD

Title
 NATIONAL GRID
 (YORKSHIRE GREEN ENERGY ENABLEMENT PROJECT) ORDER
 LAND PLAN
 REGULATION 5(2)(i) - (ii)(iii)
 SECTION B, SHEET 4 OF 5

Application Number
 EN020024

National Grid Drawing Reference
 DCO_B/LP/PS/04

Scale	Sheet Size	Sheet	Issue
1:2,500	A0	SHEET 4 OF 5	C

Nether Poppleton →



NATIONAL GRID (YORKSHIRE GREEN ENERGY ENABLEMENT PROJECT) ORDER
 LAND PLAN
 REGULATION 5(2)(i) - (ii)(iii)
 SECTION B, SHEET 5 OF 5

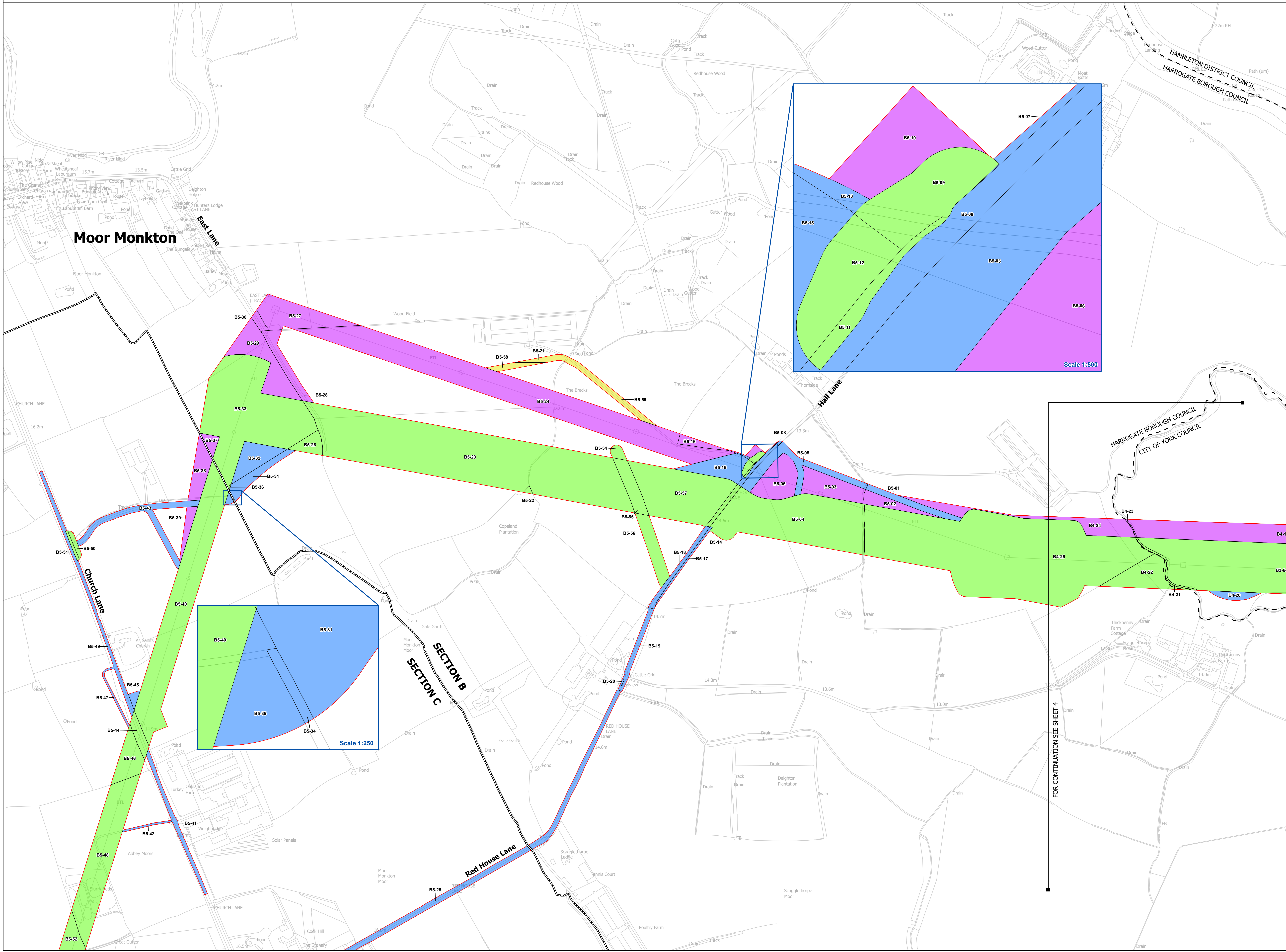
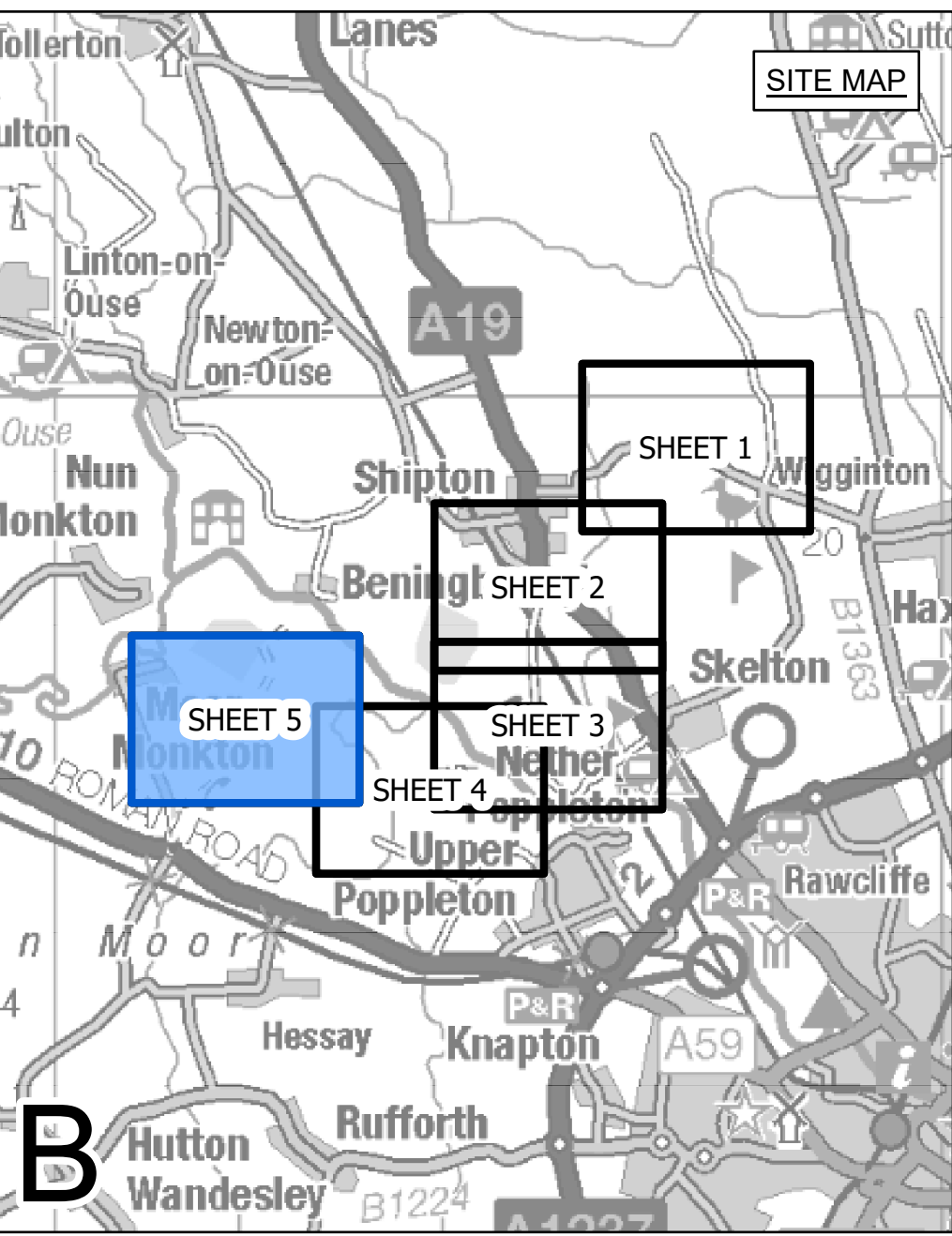

- LEGEND**
- LOCAL AUTHORITY BOUNDARY
 - SECTION BOUNDARY
 - ORDER LIMITS
- PLOTS**
- CLASS 1 - COMPULSORY ACQUISITION OF LAND
 - CLASS 2 - COMPULSORY ACQUISITION OF RIGHTS FOR THE AUTHORISED DEVELOPMENT
 - CLASS 3 - COMPULSORY ACQUISITION OF RIGHTS OF ACCESS
 - CLASS 4 - TEMPORARY USE FOR CONSTRUCTION AND MITIGATION
 - CLASS 5 - TEMPORARY USE FOR DISMANTLING
 - CLASS 6 - TEMPORARY USE FOR ACCESS

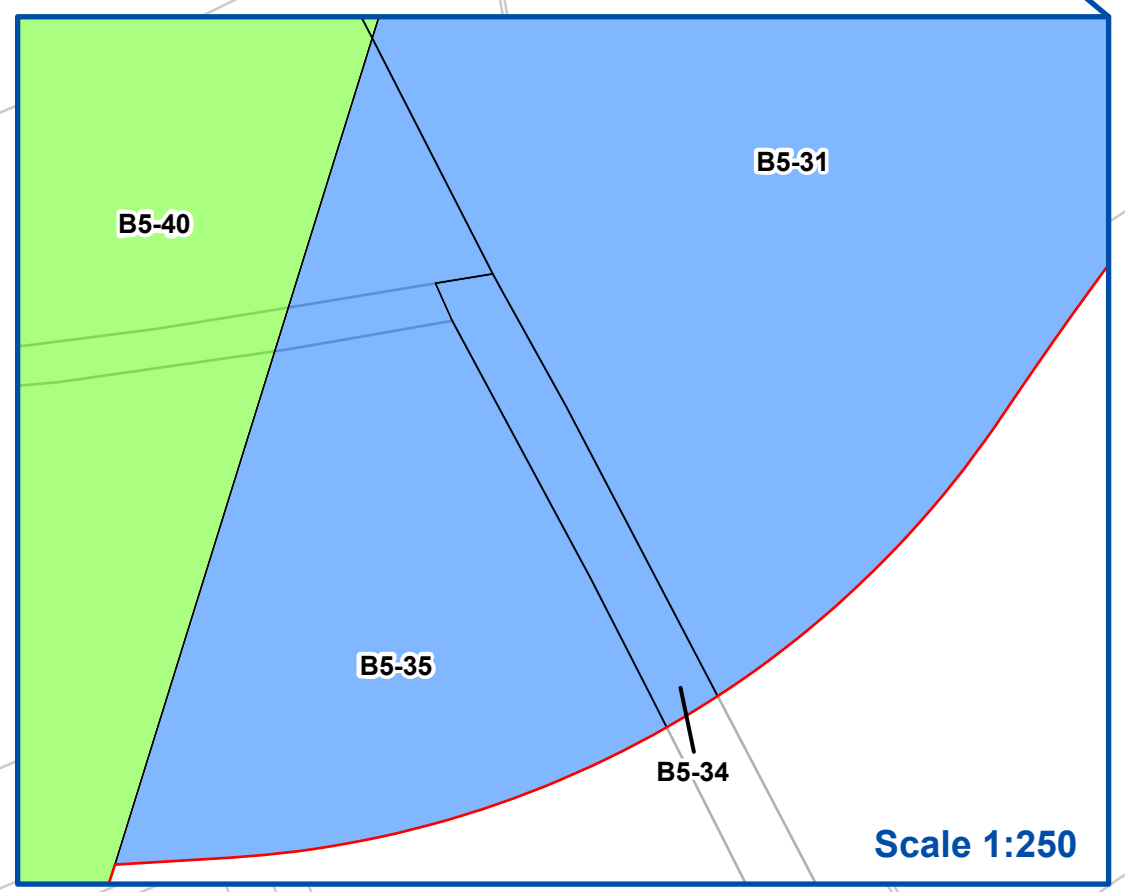
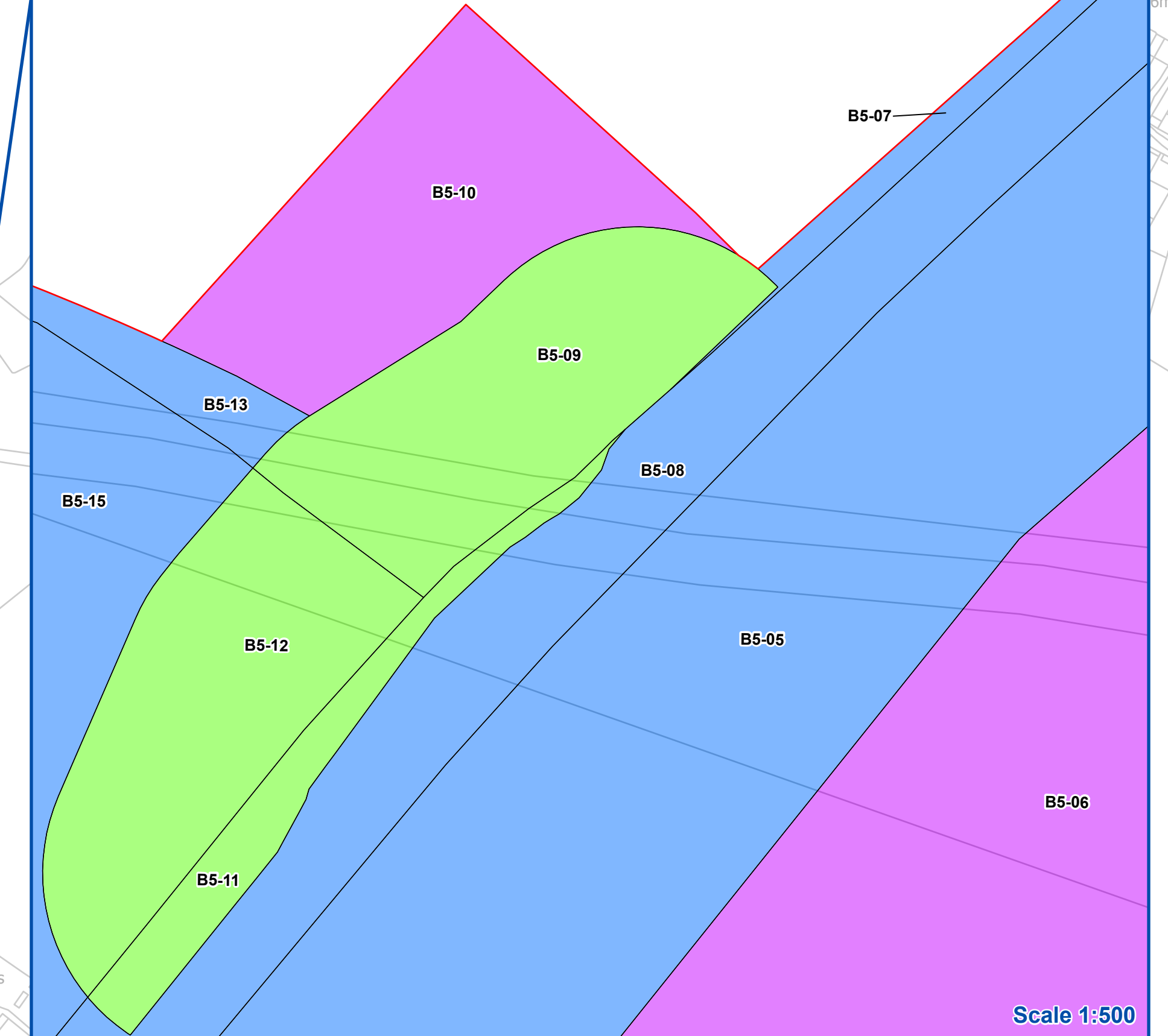

Notes
 This drawing is scaled at paper size A0, therefore any prints taken at smaller sizes will affect accuracy of the measurement units and should not be scaled against.
 All easements, servitudes and private rights are proposed to be extinguished on land that is to be acquired unless stated otherwise in the Book of Reference (Volume 4, Document 4.3).

For additional detail on the plan suites, please refer to Document 2.3 Plan Guidance Document, located in Volume 2 of the DCO Application.
 The local authorities' boundaries and titles are correct at the time of submission. North Yorkshire County Council and its 7 districts are expected to form a new single council (North Yorkshire Council) on 1 April 2023.

Coordinate System: British National Grid
 Sheet X Centroid Coordinate: 452136 Sheet Y Centroid Coordinate: 456359

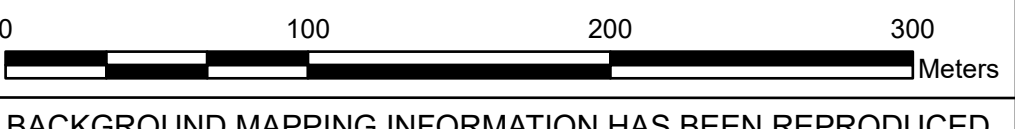

BACKGROUND MAPPING INFORMATION HAS BEEN REPRODUCED FROM THE ORDNANCE SURVEY BY PERMISSION OF ORDNANCE SURVEY OF THE CONTROLLER OF HER MAJESTY'S STATIONERY OFFICE. CROWN COPYRIGHT ORDNANCE SURVEY © BLUESKY INTERNATIONAL LTD © NATIONAL GRID ELECTRICITY - 100024241.

Issue	Date	Remarks	Drawn	Checked	Approved
C	26/04/2023	FOR DEADLINE TWO	MG	SF	EMD
B	14/02/2023	SS1 ADVICE UPDATE	MG	SF	EMD
A	01/11/2022	FOR DCO SUBMISSION	MG	SF	EMD

Title
 NATIONAL GRID (YORKSHIRE GREEN ENERGY ENABLEMENT PROJECT) ORDER
 LAND PLAN
 REGULATION 5(2)(i) - (ii)(iii)
 SECTION B, SHEET 5 OF 5

Application Number		EN020024		
National Grid Drawing Reference		DCO_B/LP/PS/05		
Scale	Sheet Size	Sheet	Issue	
1:2,500	A0	SHEET 5 OF 5	C	